

NOTE

- 1. RATING : DC 12V 50mA
- 2. CONTACT RESISTANCE : 100mΩMAX
- 3. GENERAL TOLERANCE : +/- 0.2 mm
- 4. MANUFACTURING SPECIFICATION
WOULD BE ACCORDANCE WITH WT0158
- 5. PART NO.(P/N.):

TS100AM - * **R** - **T** - **R**
 2.9X3.9
 RIGHT ANGLE
 F TYPE

□=WITHOUT MYLAR
 T=MYLAR

PACKING
 R=REEL

OPERATING FORCE
 H=220gf

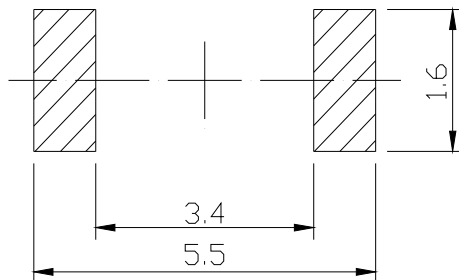

P.C.B LAND DIMENSION

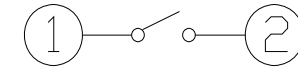
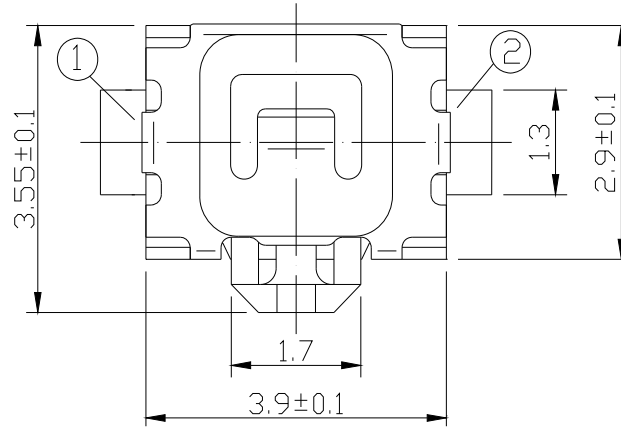

CIRCUIT DIAGRAM

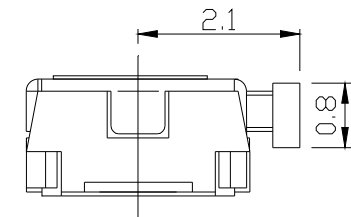
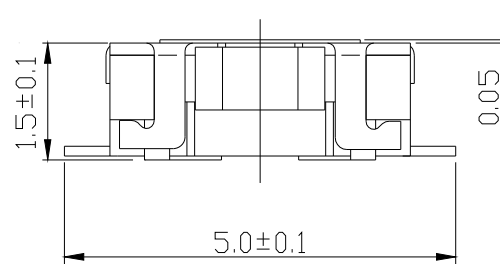

RevNo	Revision note	Date	Signature

Designed by	L.Y.D						
Checked by							
Approved by		Unit	mm	Scale	1/1	Date	2011.10.14
Item	Tactile Switch	Tool	A-Cad	Sheet	1/1	Rev.	0
Model	2.9X3.9 F Type	Drawing name		TS100AM- * R-T-R			